

PC EXHIBIT A

PLAN NORTH
TRUE NORTH

SCOPE OF WORK:
THIS AREA IS CURRENTLY PARKING, UNDERNEATH THE EXISTING PARKING STRUCTURE PLATFORM. IN THIS AREA, WE PROPOSE TO BUILD A GEL BLASTER ARENA AS SHOWN IN THE ENLARGED FLOOR PLAN.

ROSEVILLE GOLFLAND
PARKING PROVIDED
FULL SIZE SPACES = 367
COMPACT SPACES = 22
HANDICAPPED SPACES = 15
TOTAL SPACES = 404

PARKING IN EAST PARKING LOT (ACROSS THE STREET)
FULL SIZE SPACES = 166
COMPACT SPACES = 10
TOTAL SPACES = 176

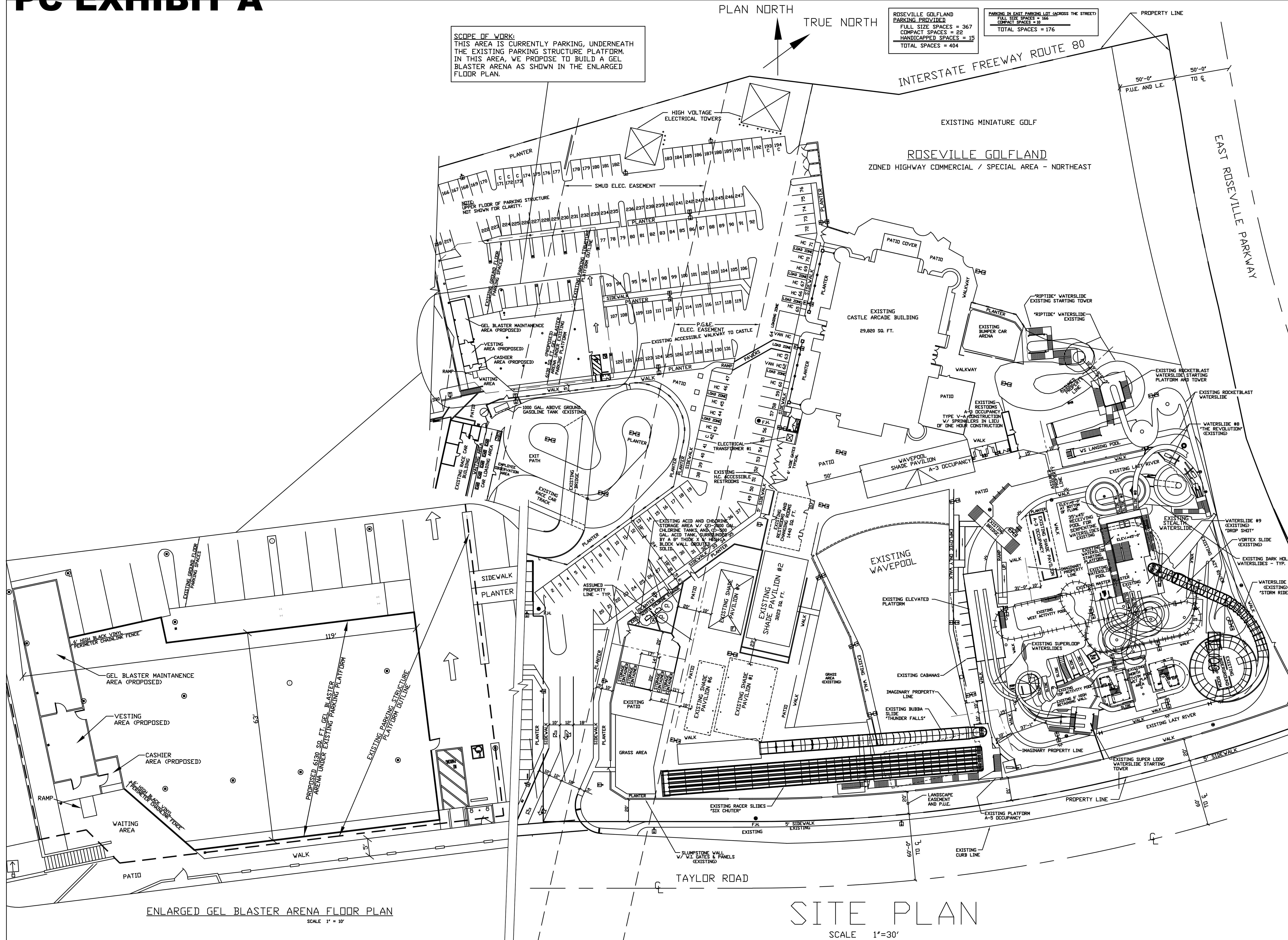

ENLARGED GEL BLASTER ARENA FLOOR PLAN
SCALE 1" = 10'

SITE PLAN
SCALE 1" = 30'

REV.	DATE	DESCRIPTION	BY
-	1-1-24	C:\ROSE\GB_CUP_R_SIGN.U	FBK

ROSEVILLE GOLFLAND - GEL BLASTER ARENA USE PERMIT MODIFICATION 2024
EJNSE INC. 9718 FAIR OAKS BLVD., SUITE A FAIR OAKS, CA 95628 PH. (916) 966-5400
GOLFLAND ENTERTAINMENT CENTERS, INC. FRED KENNEY 1893 TAYLOR ROAD ROSEVILLE, CA 95661 PH. (916) 784-1273
ROSEVILLE GOLFLAND 1893 TAYLOR ROAD ROSEVILLE, CALIF. 95661